

CBL STRENGTHS

Engineering Strength

CBL's highly skilled engineering team is experienced in international design standards, system analysis, stress analysis, safety, maintainability and reliability techniques along with unmatched expertise in the design of turnkey projects. Decades of experience, industry insight, and specialized analysis and design skills give CBL a clear edge over the competition.

Powerful Manufacturing

CBL's manufacturing strength spreads on over 1,00,000 m² Land area across 3 specialized plants equipped with modern automated systems and world class machineries from reputed global brands. The facilities also house advanced laboratory for testing and quality assurance processes.

Quality Assurance & Management Systems

CBL's quality assurance initiatives ensure that each product meets the highest standards of safety and reliability along with performance and cost effectiveness for our customers. CBL has elaborate quality assurance systems including its own in-house laboratory set up for product development & for carrying out application testing.

CBL FOLLOWS WORLD'S BEST QUALITY STANDARDS

ISO : 9001
ISO : 14001
OHSAS : 18001

RDSO
Approved

ASME (U) & (S)
Certifications

Recognized
Star Export House

Moreover, CBL has established an International Welding Training Institute in collaboration with IL&FS Skills Development Corporation Limited (IL& FS Skills)



Head Office: SCO, 523-24, Sector 70, Mohali (Punjab) INDIA

Tel: +91-172-5090 487, 5055 666 Fax: +91-172-5090 486 E-mail: marketing@cheemaboilers.com

Works: Ban Majra, Kurali Distt. Ropar (Punjab) Tel: +91-160-5005 800-02

Delhi: 504, K.M. Trade Tower, Radisson Hotel, Kaushambi, Ghaziabad, Delhi NCR

Tel: +91-120-4902510/11/12 Fax: +91-120-4902513 E-mail: mktgdelhi@cheemaboilers.com

Ahmedabad: 305 Matrix, Near Vodafone House, Corporate Road, off: S G Highway, Ahmedabad-380 051

Tel: +91-79-40030370 E-mail: cblahmedabad@cheemaboilers.com

Mumbai: 708, Swastik Chambers, C.S.T Road, Chembur, Mumbai-400 071

Tel: +91-22-25246031/37 E-mail: cblmumbai@cheemaboilers.com

Hyderabad: D.No. 7-1414/19, Flat No. 301 B, Nagasai Niwas, Srinivas Nagar (E) S.R.Nagar, Hyderabad-500 038

Tel: +91-40-6682 1160 Telefax: +91-40-6682 1161 E-mail: cheemahyd@cheemaboilers.com

Chennai: No 32, Ground Floor, Anna Nagar Plaza C-47, 2nd Avenue, Anna Nagar Chennai-600 040

Mob: +91-9884645013 E-mail: cblchennai@cheemaboilers.com

Kolkata: 3/33, R.K.Chatterjee Road, P.O Kasba. 1st Floor, (opp. old Police Station) Kolkata-700 042

Tel-033-24410452 E-mail: cblkol@cheemaboilers.com

for more information, visit www.cheemaboilers.com

All accessories shown do not form part of standard supply.
"In view of our endeavour to improve the quality of our products, the Company reserve the right to alter or change specifications without prior notice"



ROBUST
Steel Structures

CBL Structure Division
RDSO Approved

Cheema Boilers Limited is India's leading engineering solutions company serving industry's diverse requirements for over 25 years. CBL has widely earned recognition as a research driven organization that sets benchmarks for innovative technologies.

Over the years, CBL has established itself as a quality supplier of wide range of Steel Structures that stand out for their composition strength, excellent durability and matchless functionality.

CBL operates with a large sales and service network covering entire India as well as many global locations.



ROBUST Steel Structures

CBL manufactures and supplies a wide range of products that includes Steel Girders such as: CBL manufactures large sizes of heavy H-beam & Box Beam Steel Girders at its state-of-the-art facilities equipped with imported Automatic Fabrication and Assembly Lines, CNC Plate Cutting Machine, Assembly Machine, Submerged Arc Welding, Straightening and Face Milling Machine along with CNC Drilling, Blasting, Metalizing and Airless Painting facilities.

Composite Steel Plate Girder

The composite girders are fabricated for Road Over Bridges & Rail Bridges. CBL also offers erection facilities for composite plate girders through its dedicated and highly capable erection team.

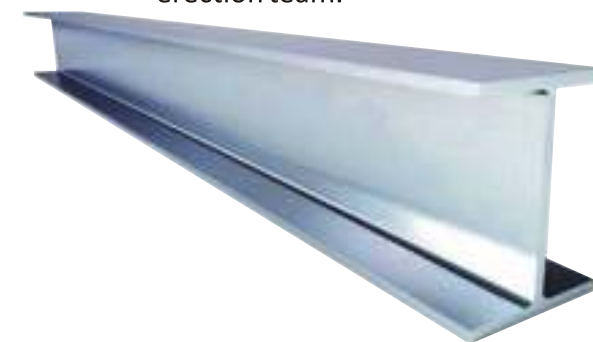

Open Web Girders/Bowstring Girders

Open web through type girders are used for diverse applications including railway track bridges over rivers, canals and valleys as well as road crossings in mountainous region. CBL open web girders are designed keeping in mind the truss type structure used for transferring loads. CBL has a team of highly qualified engineers for fabrication and erection of open web girders.

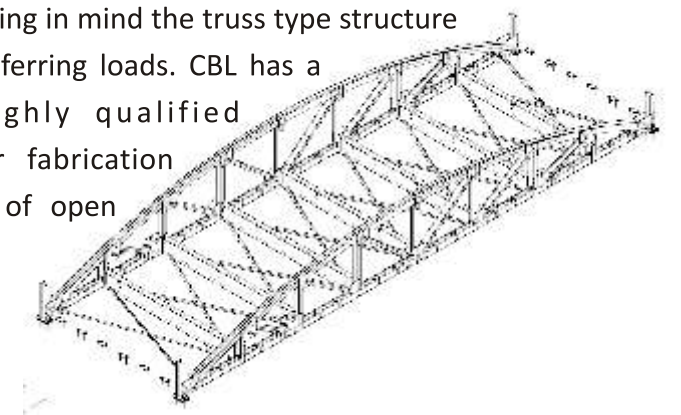

Road Over Bridge

With heavy and fast flowing traffic of modern times, Road over bridges have become a vital re-quirement for reducing traffic congestion and increasing safety. The design of each Road over bridge and use of material depends on the functional ability of the particular site where the bridge is planned - including geographic location and climatic conditions.



Foot Over Bridge

Foot over bridges are increasingly becoming popular in India due to rise in the road traffic and safety concerns for pedestrians. They are also very helpful for use in crossing small rivers and canals. CBL offers complete fabrication and erection of steel structure for Foot over Bridges.



Manufacturing Facilities

CBL's manufacturing strength spreads on over 1,00,000m² area with covered area of over 25,000m² and a storage area of over 15,000m² with a plant capacity of up to 2500 MT/Month.

RDSO approved shop for Fabrication and supply of steel structure.

The Structure manufacturing facilities at Cheema Boilers Limited are approved by RDSO (Research Design and Standards Organization) and include automated fabrication machinery, testing facilities, quality assurance processes, and trained manpower.

CBL structures are manufactured using quality raw material that ensures their robustness and corrosion resistance quality.

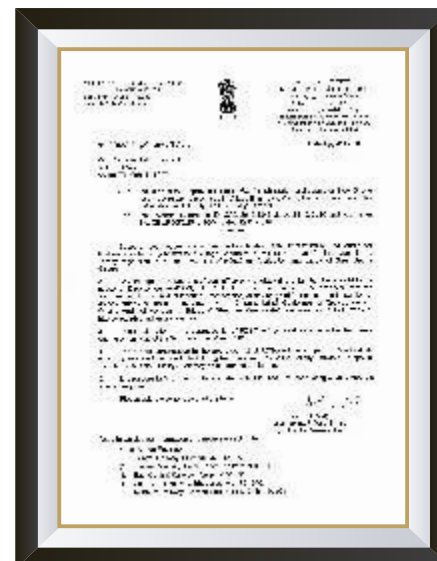

RDSO Certificate

CBL's structure fabrication shop is equipped with following equipment:

- Plate Rolling - Up to 65mm in cold rolling & up to 110mm in hot rolling
- Welding capabilities - Stud Welding, SAW, SMAW, GMAW, GTAW, FCAW
- Radial drill capacity - Up to 70 mm
- CNC gas cutting
 - Up to 16 mm thickness for Plasma
 - Up to 150 mm thickness for OXY-LPG gas cutting
- Special purpose machines for Structure welding and Structure straightening press (200 TON)
- Sand blasting machines
- Shot blasting machine with 2500mm width
- H beam assembly machine with Flange width upto 800mm & Web height upto 3500mm
- H beam welding machine with Flange width 200-800mm, Flange thickness 6-60mm
- Beam Straightening machine
- End Face Milling machine - 1200 x 2000mm
- Box beam welding machine - 16-80mm with Speed 240-2400 mm/min
- Box beam assembly machine - 300-1500 mm
- Metalizing and Painting facilities
- Well equipped Machine Shop



Quality Assurance Systems

CBL's quality assurance initiatives ensure that each product meets the highest standards of safety and reliability along with performance and cost effectiveness. CBL has elaborate quality assurance systems including its own in-house laboratory set up for product development & for carrying out application testing .CBL's Laboratory is approved by Central Boiler Board as a **Well known Material Testing Laboratory**.

The laboratory is equipped with facilities like:



Mechanical Testing Facilities

Both NDT (Non Destructive Testing) and DT (Destructive Testing) facilities including Tensile testing, Impact Testing, Insitu Alloy Analyzer, Portable Metallographic, Metallurgical Microscope X-1000 with Photography facility, Recordable/ Mechanized, Ultrasonic Testing, Magnetic particle Testing, Liquid Penetrant Testing, Visual Testing, Portable Hardness Tester, Rockwell Hardness Testing Machine, Ultrasonic Thickness Measurement, DFT Gauge

Radiography

For Carbon steel, Alloy steel and Stainless steel materials up to 150 mm (6 inch) thickness.

Our Structure manufacturing facilities are equipped with modern automated systems and world class machineries

